

36 446 000 ESSENCE E INFRARED ELECTRONIC BASIN MIXER 1/2" WITHOUT MIXING DEVICE

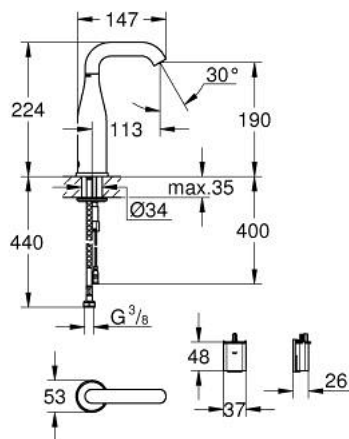

PRODUCT DESCRIPTION

- Colour: chrome
- with infrared sensor for bi-directional communication for monitoring, configuration and servicing
- for cold or premixed water
- 6V lithium battery, type CR-P2
- battery lifetime: approx. 7 years (150 actuations a day)
- GROHE Long-Life finish
- GROHE Water Saving - Less water, perfect flow
- maximum flow rate (at 3 bar): 5 l/min
- adjustable swivel area 0° / 150° / 360°
- laminar spray regulator
- flexible connecting hose
- dirt strainer
- with integrated solenoid valve
- external battery
- rapid-installation-system
- multistage battery status display
- 7 pre-set programs:
 - auto flush
 - thermal disinfection
 - cleaning mode
- additional functions and precise settings by remote control 36 407
- CE approved
- noise classification 1 in accordance with DIN4109
- type of protection faucet IP 59K
- minimum pressure 1,0 bar

36 446 000 ESSENCE E INFRARED ELECTRONIC BASIN MIXER 1/2" WITHOUT MIXING DEVICE

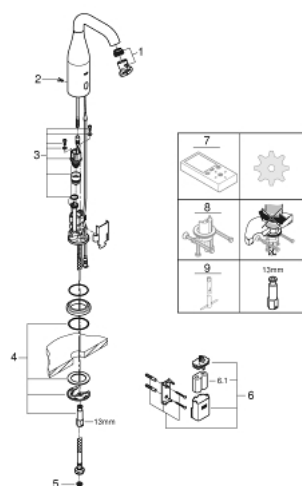

UNITS PER PACKAGE , September 2016 – now

- 1: Flow straightener (Spare part-nr. 48376000)
 - 2: Screw (Spare part-nr. 4283100M)
 - 3: Solenoid valve (Spare part-nr. 42479000)
 - 4: Mounting set (Spare part-nr. 42400000)
 - 5: Filter (Spare part-nr. 4241300M)
 - 6: Battery housing with battery (Spare part-nr. 42393000)
 - 6.1: Battery (Spare part-nr. 42886000)
 - 7: Remote control (Spare part-nr. 36407001)*
 - 8: Rotation lock (Spare part-nr. 36276000)*
 - 9: Mounting wrench (Spare part-nr. 19017000)*
- * Optional accessories