

32 652 001 ATRIO SINGLE-LEVER BATH/SHOWER MIXER

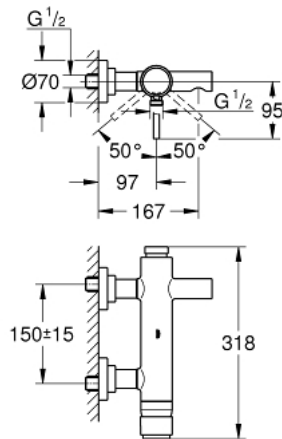

PRODUCT DESCRIPTION

- Colour: chrome
- wall mounted
- GROHE SilkMove 46 mm ceramic cartridge
- GROHE Long-Life finish
- adjustable flow rate limiter
- automatic diverter: bath/shower
- cast spout
- mousseur
- shower outlet below 1/2" with integrated non return-valve
- covered S-unions
- Protected against backflow

32 652 001 **ATRIO SINGLE-LEVER BATH/SHOWER MIXER**

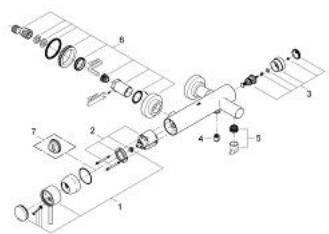

UNITS PER PACKAGE, October 2007 – now

- 1: Lever (Spare part-nr. 46634000)
- 2: Cartridge (Spare part-nr. 46048000)
- 3: Diverter (Spare part-nr. 46523000)
- 4: Non-return valve (Spare part-nr. 08565000)
- 5: Mousseur (Spare part-nr. 13926000)
- 6: Screw joint (Spare part-nr. 45631000)
- 7: Temperature limiter (Spare part-nr. 46308000)*

* Optional accessories