

## 27 058 000 RAINSHOWER SYSTEM 210 SHOWER SYSTEM

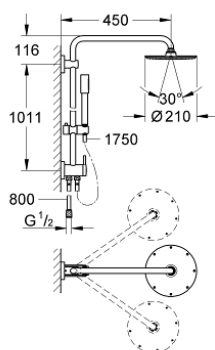

### PRODUCT DESCRIPTION

- Colour: chrome
- consists of:
  - Horizontal swivable 450 mm shower arm
  - change between hand and head shower by diverter
  - Rainshower Cosmopolitan 210 metal head shower
  - with ball joint
  - angle of rotation  $\pm 15^\circ$
  - metal stick hand shower
  - adjustable in height with gliding element
  - metal shower hose 1750 mm
- connection to water supply with 1/2"-thread of the 800 mm shower hose to faucet / wall union
- GROHE DreamSpray perfect spray pattern
- GROHE Long-Life finish
- SpeedClean anti-lime system
- Inner WaterGuide for a longer life
- suitable for instantaneous heaters (min. 19 kW/h)
- minimum flow rate 5 l/min.
- minimum pressure 1,0 bar
- recommended pressure 1.0 - 5.0 bar



## 27 058 000 RAINSHOWER SYSTEM 210 SHOWER SYSTEM

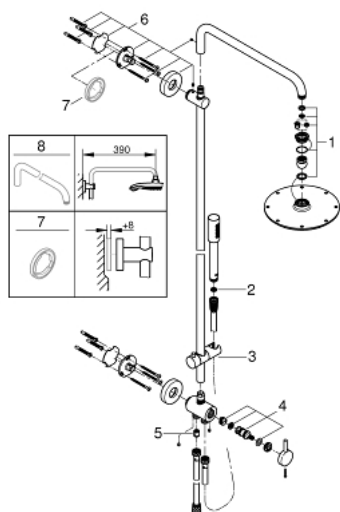

### UNITS PER PACKAGE , January 2019 – now

- 1: Inlet valve assembly (Spare part-nr. 45933000)
- 2: Dirt strainer (Spare part-nr. 0700200M)
- 3: Sliding piece (Spare part-nr. 12140000)
- 4: Repl.kit f.rotary valve (Spare part-nr. 45915000)
- 5: Non-return valve (Spare part-nr. 08565000)
- 6: Outlet shower holder (Spare part-nr. 48279000)
- 7: Compensation disc (Spare part-nr. 27180000)\*
- 8: Shower arm for shower systems (Spare part-nr. 14047000)\*

\* Optional accessories