

26 675 000 TEMPESTA COSMOPOLITAN SYSTEM 250 FLEX SHOWER SYSTEM WITH DIVERTER FOR WALL MOUNTING

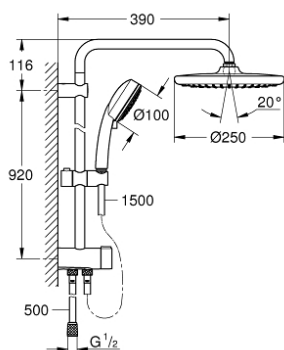
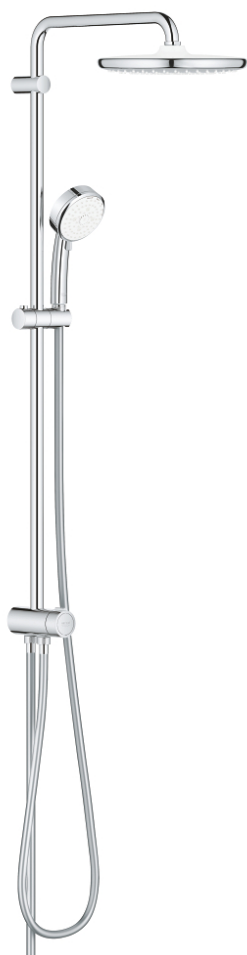

PRODUCT DESCRIPTION

- Colour: chrome
- consists of:
 - horizontal 390 mm shower arm, adjustable before installation
 - change by diverter between hand shower, head shower or head shower
- Eco setting
- head shower Tempesta 250 (26 666)
- 2 spray patterns (via diverter):
 - Rain, SmartRain
- head shower with white rear cover
- with ball joint
- rotation angle $\pm 10^\circ$
- GROHE Water Saving 9.5 l/min flow limiter
- hand shower Tempesta Cosmopolitan 100 (27 575)
- 4 spray patterns
 - GROHE Rain O², Rain, Massage, Jet
- GROHE Water Saving 9.5 l/min flow limiter
- adjustable in height with gliding element
- distance between diverter and upper bracket: 920 mm
- Relexaflex shower hose 1500 mm 1/2" x 1/2"
- Relexaflex shower hose 500 mm 1/2" x 1/2"
- flexible installation: connection to faucet / wall union for water supply with 1/2" thread of the 500 mm shower hose
- GROHE Water Saving - Less water, perfect flow
- GROHE DreamSpray perfect spray pattern
- GROHE Long-Life finish
- SpeedClean anti-lime system
- Inner WaterGuide for a longer life
- suitable for instantaneous heaters (min. 19 kW/h)
- minimum flow rate 7 l/min.
- minimum pressure 1,0 bar
- professional edition

26 675 000 TEMPESTA COSMOPOLITAN SYSTEM 250 FLEX SHOWER SYSTEM WITH DIVERTER FOR WALL MOUNTING

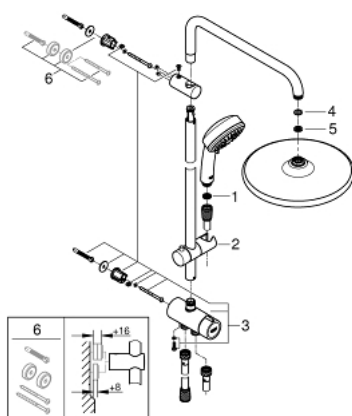

UNITS PER PACKAGE , February 2019 – now

- 1: Dirt strainer (Order-nr. 0700200M)
- 2: Sliding piece (Order-nr. 12140000)
- 3: Diverter (Order-nr. 48338000)
- 4: Fibre seal dia. 12x2 mm (Order-nr. 0138900M)
- 5: Dirt strainer (Order-nr. 48007000)
- 6: Compensation disc (Order-nr. 26496000)*
- * Optional accessories