

## 26 243 000 EUPHORIA SYSTEM SHOWER SYSTEM WITH BATH THERMOSTAT FOR WALL MOUNTING

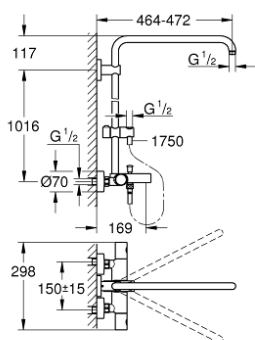

### PRODUCT DESCRIPTION

- Colour: chrome
- with short shower rail for installation in showers
- consists of:
  - Horizontal swivable 450 mm shower arm
  - exposed thermostat with Aquadimmer function
  - separate diverter for hand shower
  - gliding element
  - shower hose Silverflex 1750 mm(28 388)
  - distance between thermostat and upper bracket: 1016 mm
  - GROHE TurboStat compact cartridge with wax thermoelement
  - GROHE SafeStop at 38°C
  - GROHE SafeStop Plus optional temperature limiter at 43°C included
  - GROHE Long-Life finish
  - Inner WaterGuide for a longer life
  - TwistStop (to prevent hose from twisting)
  - suitable for instantaneous heaters (min. 19 kW/h)
  - minimum flow rate 7 l/min.



## 26 243 000 EUPHORIA SYSTEM SHOWER SYSTEM WITH BATH THERMOSTAT FOR WALL MOUNTING

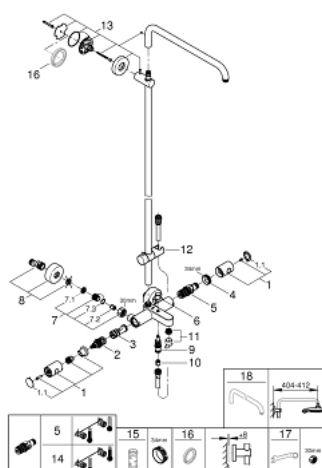

### UNITS PER PACKAGE , July 2017 – March 2021

- 1: Costa metal handle 1/2" (Order-nr. 47984000)
  - 1.1: Cap (Order-nr. 6458500M)
  - 2: Aquadimmer (Order-nr. 47364000)
  - 3: Water flow (Order-nr. 47887000)
  - 4: Fitting ring (Order-nr. 47743000)
  - 5: Thermostatic compact cartridge 1/2" (Order-nr. 47439000)
  - 6: Diverter knob (Order-nr. 65648000)
  - 7: Non-return valve (Order-nr. 47189000)
  - 7.1: Dirt Strainer (Order-nr. 0726400M)
  - 7.2: Non-return valve (Order-nr. 08565000)
  - 7.3: O-ring  $\varnothing 17 \times \varnothing 2$  (Order-nr. 0305500M)
  - 8: S-union (Order-nr. 12662000)
  - 9: Diverter (Order-nr. 65655000)
  - 10: Non-return valve (Order-nr. 08565000)
  - 11: Mousseur (Order-nr. 13926000)
  - 12: Sliding piece (Order-nr. 12140000)
  - 13: Outlet shower holder (Order-nr. 48279000)
  - 14: GROHE TurboStat cartridge 1/2" (Order-nr. 47175000)\*
  - 15: Socket spanner (Order-nr. 19332000)\*
  - 16: Compensation disc (Order-nr. 27180000)\*
  - 17: Special spanner (Order-nr. 19377000)\*
  - 18: Shower arm for shower systems (Order-nr. 14047000)\*
- \* Optional accessories