

24 025 EN0 **KENSINGTON 3-HOLE BIDET MIXER**



PRODUCT DESCRIPTION

- Colour: brushed nickel
- without handles
- rim flush/bidet spray
- Integral Atmospheric Vacuum Breaker
- ceramic headparts 1/2", 90°
- pop-up waste set 1 1/4"
- pressure-proof, flexible connection hoses between spout and side valves
- GROHE Long-Life finish
- round handles 18 086 000 & 18 086 EN0 (sold separately)
- Swarovski crystal handles 18 086 VP0 (sold separately)
- lever handles 18 087 000 & 18 087 EN0 (sold separately)

24 025 EN0 KENSINGTON 3-HOLE BIDET MIXER

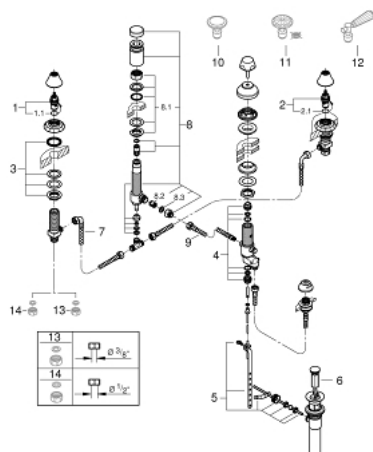

UNITS PER PACKAGE , December 2016 – now

- 1: Ceramic headpart, 1/2" (Spare part-nr. 45882000)
- 1.1: O-ring $\varnothing 18.2 \times \varnothing 1.7$ (Spare part-nr. 0392400M)
- 2: Ceramic headpart, 1/2" (Spare part-nr. 45883000)
- 2.1: O-ring $\varnothing 18.2 \times \varnothing 1.7$ (Spare part-nr. 0392400M)
- 3: Shank fastening assembly (Spare part-nr. 45025000)
- 4: Repl. kit f. seal (Spare part-nr. 45027000)
- 5: Ball rod (Spare part-nr. 48332000)
- 7: Flexible connection hose (Spare part-nr. 45704000)
- 8: Vacuum Breaker (Spare part-nr. 45852EN0)
- 8.1: Shank mounting kit (Spare part-nr. 45855000)
- 8.2: Non-return valve (Spare part-nr. 08565000)
- 8.3: Fibre seal dia. 12x2 mm (Spare part-nr. 0138900M)
- 9: Flexible connector M10x1xM15x1x350 (Spare part-nr. 46254000)
- 10: Crystal handle (Spare part-nr. 18086EN0)*
- 11: Crystal handle (Spare part-nr. 18086VP0)*
- 12: Lever Handle (Spare part-nr. 18087EN0)*
- 13: Coupling nut 1/2" x 10.5 mm (Spare part-nr. 1290100M)*
- 14: Coupling nut 1/2" x 14.5 mm (Spare part-nr. 1290200M)*

* Optional accessories