

23 845 003 GROHE PLUS 3-HOLE BATH/SOWER COMBINATION

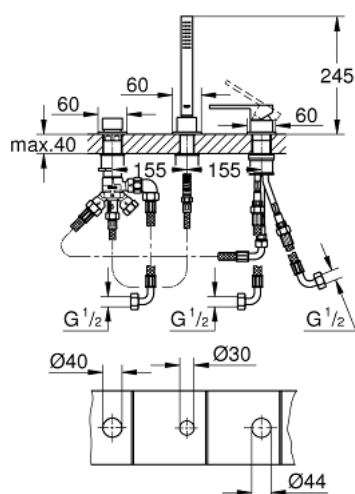

PRODUCT DESCRIPTION

- Colour: chrome
- three hole installation
- GROHE SilkMove 35 mm ceramic cartridge
- with temperature limiter
- GROHE Long-Life finish
- consists of:
 - single lever mixer operating element
 - automatic diverter: bath/shower
 - without spout
- Euphoria Cube hand shower 7.6 l/min
- metal shower hose 2000 mm (always chrome for any colour of the set)
- flexible connection hoses
- connection for shower hose
- Protected against backflow
- for use with baseframe 29 037 002 (please order separately)
- for combination with 28 990 / 28 991
- minimum pressure 1,0 bar

23 845 003 GROHE PLUS 3-HOLE BATH/SHOWER COMBINATION

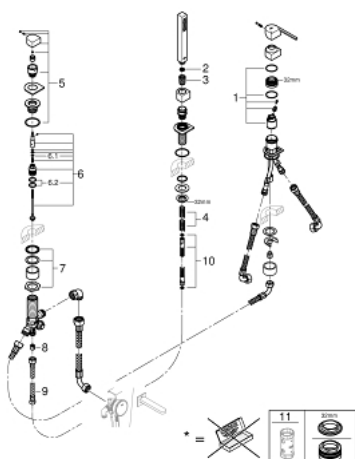

UNITS PER PACKAGE , April 2018 – now

- 1: Cartridge (Spare part-nr. 46374000)
 - 2: Dirt strainer (Spare part-nr. 0700200M)
 - 3: Cone nut (Spare part-nr. 08864000)
 - 4: Compression spring (Spare part-nr. 00869000)
 - 5: Diverter knob (Spare part-nr. 48494000)
 - 6: Diverter (Spare part-nr. 45443000)
 - 6.1: O-ring $\varnothing 6 \times \varnothing 2$ (Spare part-nr. 0128300M)
 - 6.2: Seat washer (Spare part-nr. 0120500M)
 - 7: Repl.kit f.spout shank (Spare part-nr. 45456000)
 - 8: Non-return valve (Spare part-nr. 08565000)
 - 9: Tube (Spare part-nr. 07300000)
 - 10: Metal hose (Spare part-nr. 28146000)
 - 11: Socket spanner (Spare part-nr. 19332000)*
- * Optional accessories