

22 917 000 ATLANTA ANGLE VALVE 1/2"

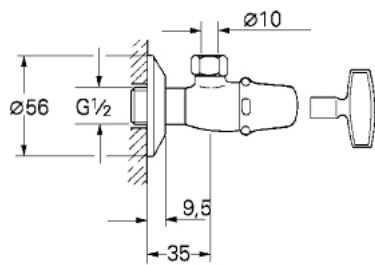

PRODUCT DESCRIPTION

- Colour: chrome
- wall connection 1/2"
- outlet thread 3/8"
- socket spanner headpart
- closed cap
- with compression nut $\varnothing 10$ mm
- Marking: neutral
- escutcheon
- GROHE Long-Life finish

22 917 000 ATLANTA ANGLE VALVE 1/2"

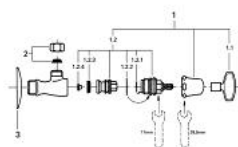

UNITS PER PACKAGE , April 2008 – now

1: Headpart 1/2" (Spare part-nr. 11148000)

1.1: Socket spanner 1/2" (Spare part-nr. 02277000)

1.2: Headpart 1/2" (Spare part-nr. 07146000)

1.2.1: O-ring $\varnothing 6 \times \varnothing 2$ (Spare part-nr. 0128300M)

1.2.2: O-ring $\varnothing 18.2 \times \varnothing 1.7$ (Spare part-nr. 0392400M)

1.2.3: Ball seal dia. 9x6.8 mm (Spare part-nr. 0529100M)

2: Compression union 3/8" (Spare part-nr. 1291400M)

3: Flange 1/2" (Spare part-nr. 02201000)