

20 405 001 **COSTA S PILLAR TAP**

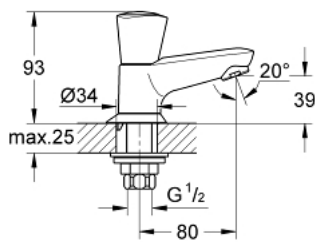

PRODUCT DESCRIPTION

- Colour: chrome
- metal handle
- heat-insulated
- screwable
- marking: blue
- Carbidur headpart
- cast spout with mousseur
- union nut 1/2" x 10,5 mm
- GROHE Long-Life finish



20 405 001 **COSTA S PILLAR TAP**

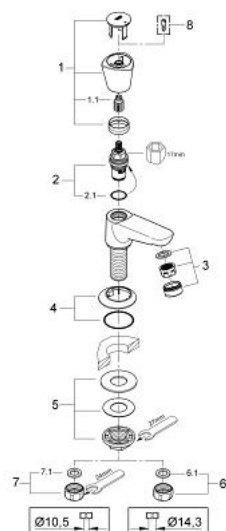

UNITS PER PACKAGE , June 2007 – now

- 1: Handle (Order-nr. 45995000)
 - 1.1: Repl. kit f.handle fastening (Order-nr. 0538600M)
 - 2: Ceramic headpart, 1/2" (Order-nr. 45346000)
 - 2.1: O-ring $\varnothing 18.2 \times \varnothing 1.7$ (Order-nr. 0392400M)
 - 3: Mousseur (Order-nr. 13929000)
 - 4: Escutcheon (Order-nr. 45996000)
 - 5: Shank fastening assembly (Order-nr. 45000000)
 - 6: Coupling nut 1/2" x 14.5 mm (Order-nr. 1290200M)
 - 6.1: Fibre seal dia. 12x2 mm (Order-nr. 0138900M)
 - 7: Coupling nut 1/2" x 10.5 mm (Order-nr. 1290100M)
 - 7.1: Fibre seal dia. 12x2 mm (Order-nr. 0138900M)
 - 8: Screw for Costa/Avina products (Order-nr. 48013000)*
- * Optional accessories