

20 351 DC0 **EUROCUBE 3-HOLE BASIN MIXER**  
**S-SIZE**

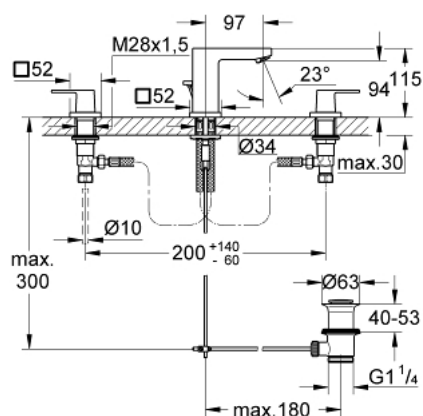

## PRODUCT DESCRIPTION

- Colour: Supersteel
- metal lever
- ceramic headparts 1/2", 90°
- GROHE Long-Life finish
- GROHE FastFixation Plus installation system
- spout with mousseur
- pop-up waste set 1 1/4"
- pressure-proof, flexible connection hoses between spout and side valves
- union nut 1/2" x 10,5 mm

## 20 351 DC0 EUROCUBE 3-HOLE BASIN MIXER S-SIZE

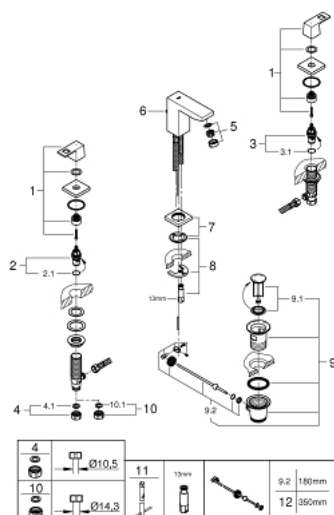

### UNITS PER PACKAGE , July 2018 – now

- 1: Handle pair (Spare part-nr. 48321DC0)
- 2: Ceramic headpart, 1/2" (Spare part-nr. 45882000)
- 2.1: O-ring Ø18.2 x Ø1.7 (Spare part-nr. 0392400M)
- 3: Ceramic headpart, 1/2" (Spare part-nr. 45883000)
- 3.1: O-ring Ø18.2 x Ø1.7 (Spare part-nr. 0392400M)
- 4: Coupling nut 1/2" x 10.5 mm (Spare part-nr. 1290100M)
- 4.1: Fibre seal dia. 12x2 mm (Spare part-nr. 0138900M)
- 5: Mousseur (Spare part-nr. 13929DC0)
- 6: Pop-up rod (Spare part-nr. 46787DC0)
- 7: Escutcheon (Spare part-nr. 48421DC0)
- 8: Shank mounting kit (Spare part-nr. 46671000)
- 9: Pop-up waste set 1 1/4" (Spare part-nr. 28910DC0)
- 9.1: Plug (Spare part-nr. 07182DC0)
- 9.2: Eccentric rod (Spare part-nr. 07052000)
- 10: Coupling nut 1/2" x 14.5 mm (Spare part-nr. 1290200M)\*
- 11: Mounting wrench (Spare part-nr. 19017000)\*
- 12: Eccentric rod (Spare part-nr. 07341000)\*

\* Optional accessories