

19 446 000 ALLURE THERMOSTAT WITH INTEGRATED 2-WAY DIVERTER FOR BATH OR SHOWER WITH MORE THAN ONE OUTLET

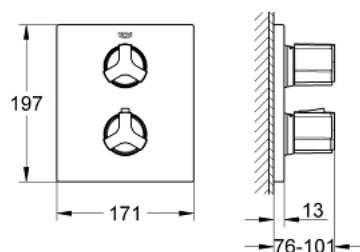

PRODUCT DESCRIPTION

- Colour: chrome
- final installation set for
- 35 500 000
- GROHE Long-Life finish
- temperature scale handle with SafeStop at 38°C
- GROHE SafeStop Plus optional temperature limiter at 43°C included
- - shut off and flow control
- Aquadimmer with multiple function
- Diverter for 2 outlets
- escutcheon- and shaft-sealing
- metal handles
- metal escutcheon
- covered coupling
- without concealed body



19 446 000 ALLURE THERMOSTAT WITH INTEGRATED 2-WAY DIVERTER FOR BATH OR SHOWER WITH MORE THAN ONE OUTLET

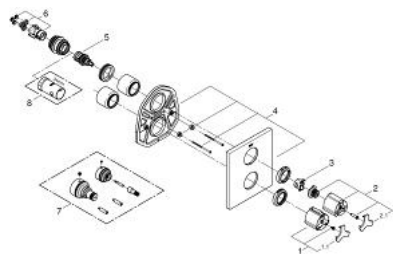

UNITS PER PACKAGE , April 2014 – now

- 1: Scale handle Neotherm (Spare part-nr. 47786000)
- 1.1: Cap (Spare part-nr. 0635600M)
- 2: Handle for shut-off valve (Spare part-nr. 47793000)
- 2.1: Cap (Spare part-nr. 0635600M)
- 3: Stop ring (Spare part-nr. 10089000)
- 4: Escutcheon (Spare part-nr. 47785000)
- 5: Aquadimmer (Spare part-nr. 47364000)
- 6: Adapter 3/4" x 1/2" (Spare part-nr. 12701000)
- 7: Extension-set, 27,5 mm (Spare part-nr. 47781000)*
- 8: Socket spanner (Spare part-nr. 19332000)*

* Optional accessories